

VAN DE WEELE

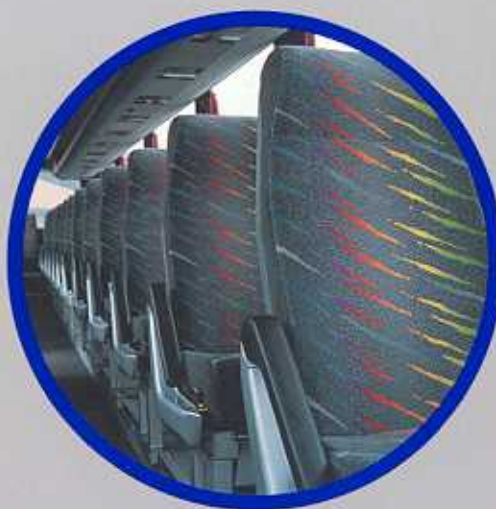

VELVET TRONIC
VTR



VELVET TRONIC VTR 23



The Velvet Tronic VTR is a double rapier machine that weaves velvet according to the face-to-face technique.

The VTR 23, in excenter or dobbytronic execution, weaves plain and dobby designed velvet.

The flexibility together with the high weaving speed of the Velvet Tronic, allows the velvet industry to fulfill the strict market demands of quality and delivery time.

VELVET TRONIC **VTR** VELVET WEAVING INTO THE FUTURE

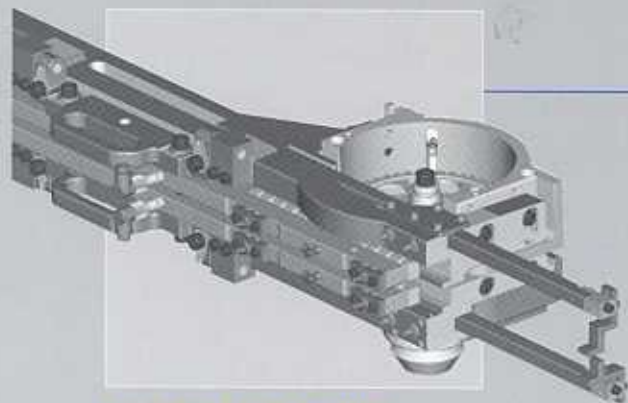

GUIDING OF THE RAPIERS

The rapiers are guided on air cushions without roller guiding. The clearance between the dents of the rapier rack and the drive gear is easily adjustable.

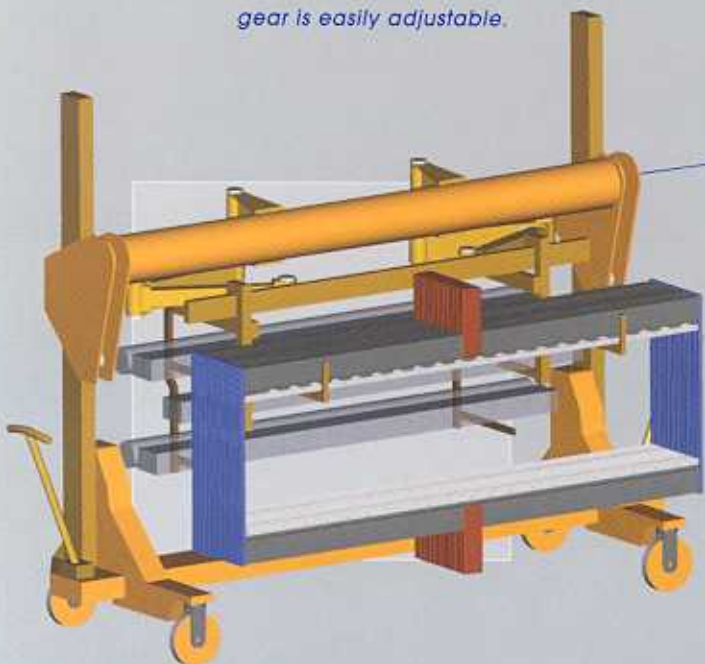

QUICK STYLE CHANGE CAPABILITY

An optional "quick style change system" shortens the time of drawing-inn drastically which increases productivity of the machine accordingly.

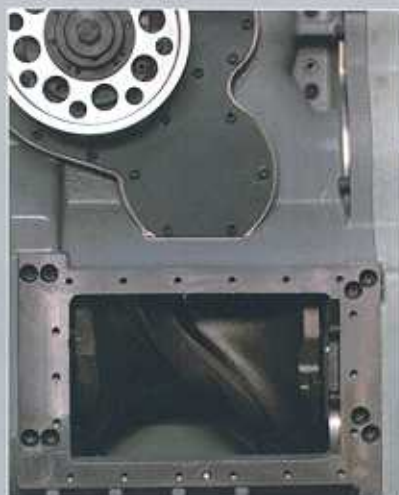

CUTTING MOTION

The cutting motion is driven by a rigid three-dimensional cam in order to achieve a high speed cutting at each pick.

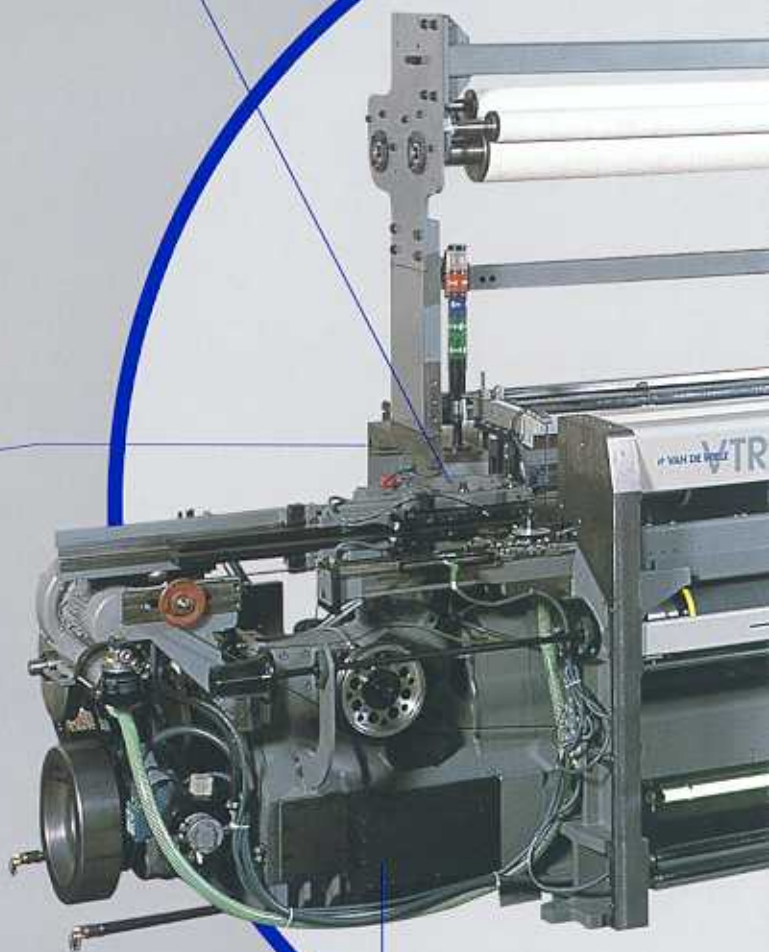

PILE DELIVERY

The pile delivery is driven by servomotors. This enables an accurate pile delivery and pile height control in a wide range.



MICROPROCESSOR

The machine is controlled by a microprocessor and equipped with a 12" colour touch screen.



FILLING SCISSORS WITH PRESENTATION DEVICE

When weaving without filling selector, 50% savings on false selvedge fillings.

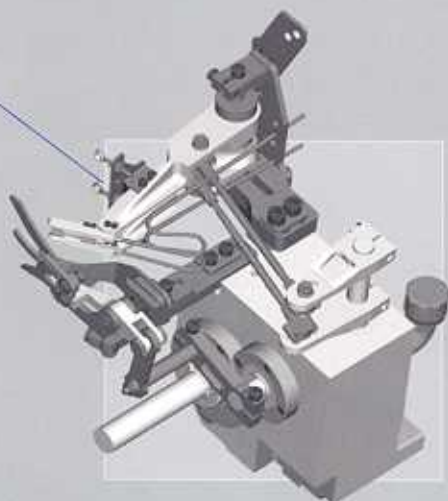

DOBBYTRONIC

The Dobbytronic in bottom position and the quick connection system for the heddle frames endure stability and easy access for style changes.



WE KEEP PROVING IT!



VELVET TRONIC VTR33

The Velvet Tronic VTR 33
 equipped for light carpets.
 A wide variety of pile yarns
 (viscose, cotton, wool, acryl,
 polyester, polyamide,
 polypropylene...)
 can be woven in different
 pick densities.

The Velvet Tronic VTR 33
 equipped with an electronic
 Multi Hook jacquard machine.
 This VTR 33 weaves
 face-to-face jacquard velvet
 for upholstery.



SELECTOR

- single coil solenoid
- low friction guidance



HOOKS

- lightweight nickel plated flexible hook
- no need for springs, levers and pivots



CAM BOX

- complementary cam system enabling high speed operation
- cams in sealed oil bath (low maintenance, high reliability)

VELVET TRONIC

VTR23 DOBBY - VTR33 JACQUARD

- Nominal widths: 175-195-215-265 cm
max. overall reed width
- Weft insertion: Up to 2 x 500 rpm or 1500 m/min
by double rigid rapiers
guide on air cushions
without roller guidings
- Weft presentation: Scissors independent of the reed,
eliminating the right hand side false
selvedge when weaving without weft
selector
- Ergonomics: Easy access for operating the machine
and for style changes
- Stability: Gearboxes integrated in the main frame
with balanced reed and rapier motion
- Machine Control: By 12" colour touch screen - PC based
- Rapier stroke: Steplessly adjustable for optimal
weft insertion and transfer
- Pick regulator: Servomotor driven
with software to prevent start marks
- Pick finding: Automatic pick finding at reduced
speed
- Cutting motion: Driven by three-dimensional conjugated
cams, cutting at each pick, even at high
speed by knife carriage guided on
independent swallow tail profile
- Weft selector: On top and bottom rapier,
up to 8 colours
- Cloth take-up: 2 x Ø 800 mm, alt. 2 x Ø 1250 mm
- Woven velvet: From chiffon velvet to technical long pile
- Qualities: fabrics : 200 to 2000 g/m²
upholstery and automotive velvet
lady dress and ecological fur
light carpet and prayer rugs

VTR23 DOBBY

- Dobby execution: With Dobbytronic DTR up to 10 pile shafts
- Pile deliveries: Up to 3, servomotor driven,
for optimal pile height control
- Beamstand: 2 x max. Ø 1250 or 3 x max. Ø 1000
In pile warp and 2 x max. Ø 1000 in
ground warp with electrical let-off

VTR33 JACQUARD

- Jacquard execution: With 3 position open shed MJ Multihook
electronic jacquard for upholstery and
automotive velvet,
with Piletronic for light carpets.
- Beamstand: 2 x max. Ø 1000 for ground warp
and 2 x max. Ø 1000 for reflect warp
alt. 2 x max. Ø 1250 for light carpet

VELVET TRONIC

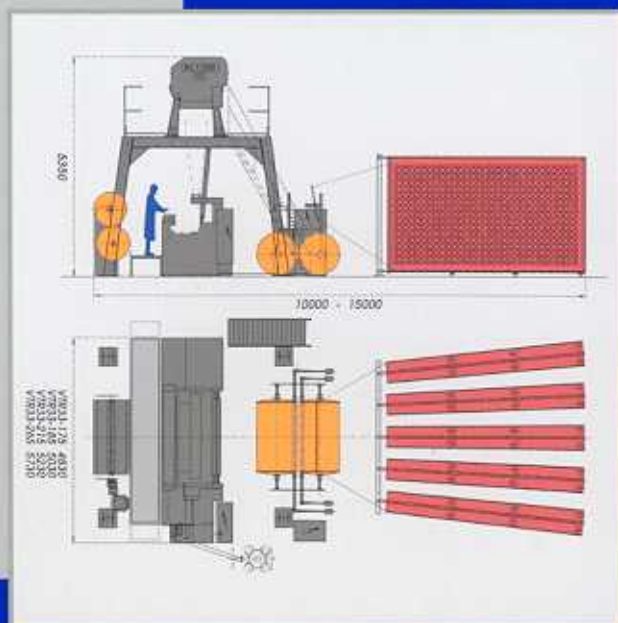
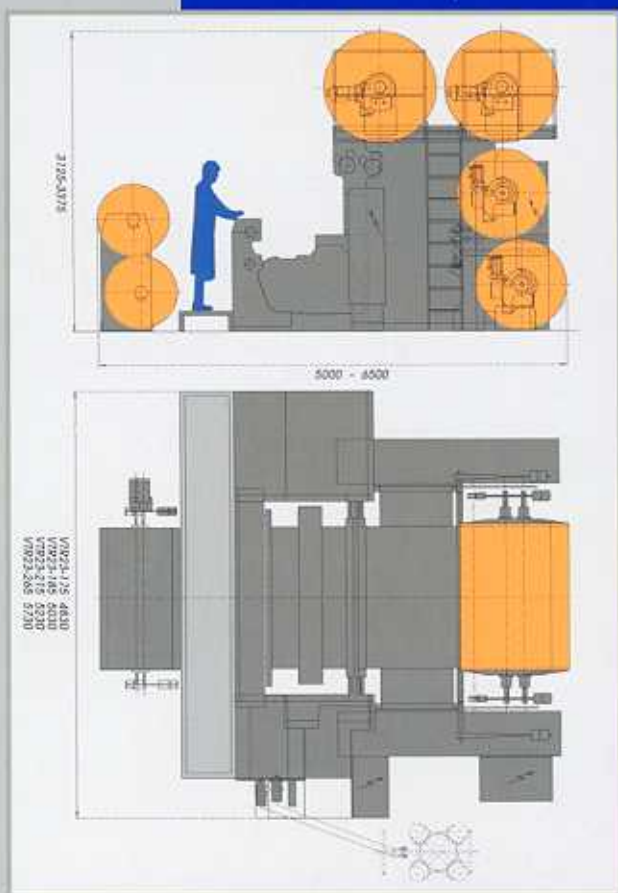

VAN DE WIELE
CARPET AND VELVET WEAVING MACHINES